

Always at the
cutting edge

Inspiration 2016



Der SonnenLichtManager





Dear WAREMA partner,

Our main mission for more than 60 years has been developing top-quality customer-oriented solutions for you. Extensive consulting services and the quickest possible delivery - these are values which are of enormous importance for us as the leading SunLightManager and from which you benefit. As a full-range provider of technical sun shading systems, we can offer you sustainable systems from a single source. This is what makes you and us so successful!

But we can get even more things going. In the year of our 60th anniversary, for example, we have set up the new "Service" division for you. Here too, we shall constantly expand our services and use our strength even more efficiently – you can find out more in this brochure. Together with you, we should also like to achieve many goals in 2016. Let us take the lead together and continue on our road to success!

We would like to invite you to visit us at the following trade fairs this coming spring:

FENSTERBAU FRONTALE (Nuremberg)

16 to 19 March 2016

Hall 7, stand 419

Light + Building (Frankfurt am Main)

13 to 18 March 2016

Hall 9.0, stand A30

There you can explore our new products, which we should like to present to you in this brochure, live.

For example, the update of our range of articulated arm awnings with the two new types G60 and H60 is pioneering. The WAREMA Colour World is now also available for the coating of the surfaces. However, we also have other new products up our sleeve, so that you can start the 2016 awning season at full speed. For example our new K50 cassette awning, with which you will also be able to inspire customers who prefer modern cubic designs.

We like to continue the outstanding success of the new 80 S external venetian blind with an upgrade of all rail-guided models of our flat slats – and with our top-mounted and venetian blind window systems for new buildings there are also some new and unique features which will allow you to stand out from your rivals.

Alexander Grundhoff

Managing Director WAREMA International GmbH

i.V. Mario Baumann

Export manager WAREMA International GmbH



General information 2016	4
– Trade fairs 2016	
– Important dates at a glance	
News from the product ranges	6
– Insect screen roller blind	
– WAREMA Colour World	
– New NA-RO and NA-RA	
New products - External venetian blinds	10
New products - Roller shutters	18
New products - Awnings	22
New products - Internal sun shading systems	26
New products - Control systems	32

At a glance
Overview 2016





Trade fairs 2016

The sun protection and season 2016 will start at the latest at the FENSTERBAU FRONTALE. The trade fair takes place from 16 - 19 March 2016 in Nuremberg. We look forward to welcoming you in Hall 7 on Stand 419!

As the leading SunLight Manager, we are also present at the world's leading trade fair for lighting and building engineering, the Light + Building in Frankfurt. Here you will find us from 13 - 18 March 2016 in Hall 9.0 on Stand A30.

Important dates at a glance

	December				January					February				March				April					May			
	49	50	51	52	1	2	3	4	5	6	7	8	9	10	11	12	13	14	15	16	17	18	19	20	21	22
FENSTERBAU FRONTALE																										
Light + Building																										



From the product ranges

New products

The WAREMA insect screen roller blind is highly versatile – also in conjunction with external venetian blinds and roller shutters. For improved operating comfort, a new handle rail that can be operated from inside and outside is now used. The optimised insect screen roller blind is available in conjunction with our front mounted roller shutters (V4, V6, V10), top-mounted roller shutters for new buildings (inspection from outside), venetian blind window system, front mounted external venetian blinds and top-mounted external venetian blinds for new buildings, and can also be ordered as a separate insect screen product.



Sectional sample with a new handle rail

All sectional samples with an integrated insect screen roller blind were brought up to date and are available with the new handle rail with immediate effect (page 6).

Make use of this opportunity to update the sectional samples in your showrooms. With true-to-scale samples, you can practically and effectively demonstrate the advantages of the new model. You can find an overview of the available sectional samples in the Marketing Material Catalogue on page 96. Your contact person from the Marketing Customer Centre will be pleased to help you if you have any questions.

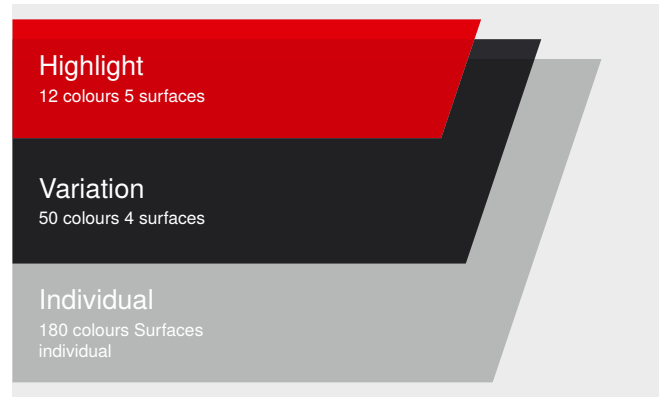

WAREMA Colour World

The WAREMA standard colour chart was revised and restructured in 2015. The result is the WAREMA Colour World. Since the conversion, the powder colours have been categorised in "Highlight", "Variation" and "Individual".

You can find further information about the WAREMA Colour World at www.warema.com/colour-world or in our WAREMA Colour World brochure (Art. No. 879528).



More colours for the awnings range

A simplification of the colour concept also took place in the awnings area. The aluminium parts of all articulated arm awnings can now also be coated in accordance with the WAREMA Colour World. Types 530, 550, 580 and K50 still represent exceptions. These are coated as standard in RAL 9016 or RAL 9006 (satin finish).

New NA-RO and NA-RA

Functional and flexible



The existing top-mounted system for new buildings was revised and further improved. Thanks to this modern new system, you can benefit immediately from numerous advantages: good heat insulation, improved sound absorbing coefficients, different window connection models and much more. In future, ventilation elements can also be integrated – either ex-works or prepared for on-site ventilation units. Convince yourself of our new, innovative WAREMA top-mounted system for new buildings! Available immediately (NA-RO) and from February 2016 (NA-RA).

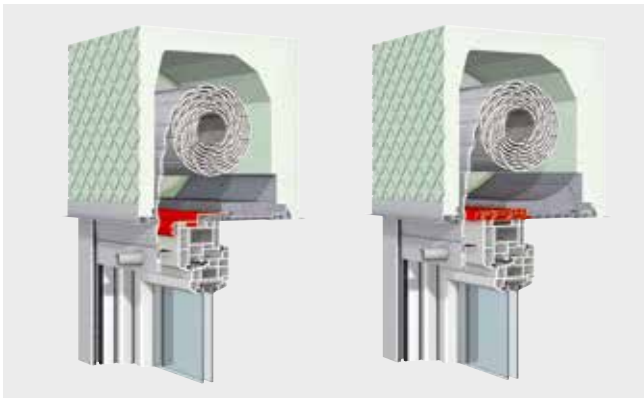

Flexible window connection

Depending on the type of inspection, the standard window connection uses either the unwind strip or a plastic profile integrated in the shutter box. In addition, clip attachment is also possible for both types of inspection. Here, a window adapter profile is attached to the window frame over its entire width. The box is then clipped onto the window adapter profile by means of an integrated basic profile. This model allows an efficient window connection and guarantees a firm connection over the entire width. The window adapter profiles are available either in plastic or also in steel to increase the rigidity of the window.

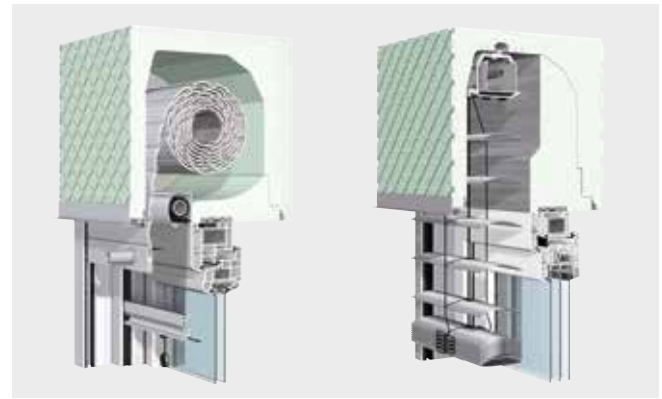

Uniform window position

For an optimum combination of top-mounted roller shutters for new buildings and top-mounted external venetian blinds for new buildings in a new building project, the NA-RO for inspection from outside is now also available with a shaft opening of 120 mm.

Your benefit: the work involved in planning is reduced, and the connection details apply for roller shutters as well as for external venetian blinds.

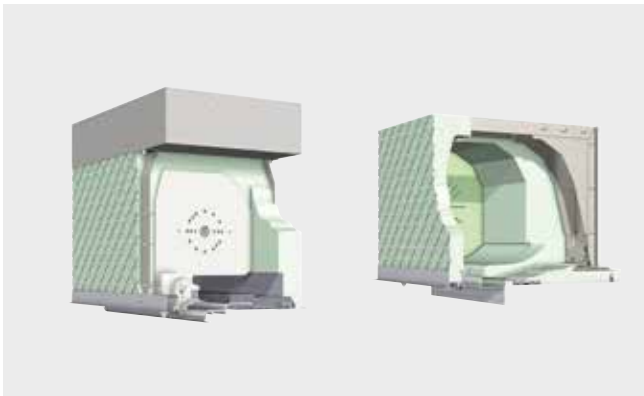

Improvement in structural strength

In combinations, the box is fitted as standard with ceiling mountings (inside and outside) in the region of the centre rail. On request, these can also be positioned at other points.

In addition, structural strength can be improved through the use of window adapter profiles made of steel and invisibly mounted structural consoles. Forces acting on the window, for example those caused by wind stress, can thus be reliably absorbed by the structure.



Greater stability thanks to new boxes

Thanks to reinforcement inserts, the revised external venetian blind boxes now offer even greater stability in the box sides. This allows better installation situations for the window in terms of energy efficiency. In particular with our top-mounted external venetian blind for new buildings, the window can move outwards up to 35 mm in the masonry compared to the previous model, which significantly improves the isothermal curve.

External venetian blinds

New products



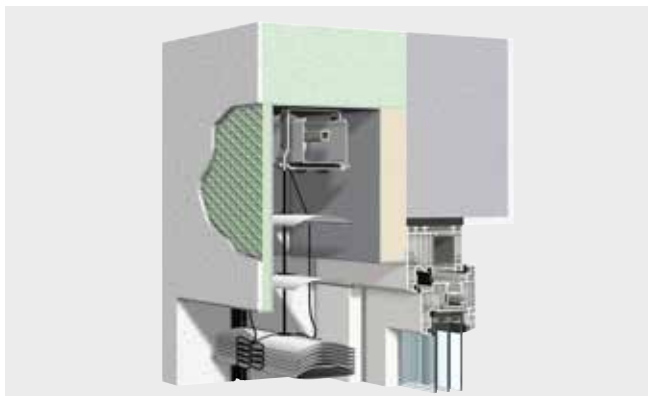

Venetian blind window system further improved

In order to support the trend towards flush-mounting solutions as best as possible, we overhauled our venetian blind window system in 2015. This system solution has now been modernised even further. From now on it is also possible to offer elements perfectly adapted to the standard insulation thicknesses of 15, 20, 30 or 40 mm. This makes it possible to equip window elements mounted in the masonry with the right sun shading systems, without any cold bridges.



More stable guides now also available for flat slats

The advantages of the 80 S external venetian blinds were transferred to all rail-guided models of the flat slat. Besides the cleaner and less obtrusive look of the 2-point ultrasonic welding, the rigidity of the slat connection is improved through the material stiffening achieved using deep-drawing technology. The flush connection points between the slats and the nipples are unique, and at the same time they are the most stable designs on the venetian blind market. The improved design of the bottom rail of the 60 S is now also included in the 60 mm flat slat.

External venetian blinds

New products



Stackable bracket lining

With a new bracket lining, we now offer the option of removing external venetian blinds simply and easily. The 6.5 mm high lining engages in the bracket or in the next lining, so that this does not also have to be held during overhead installation.

Through the use of these in conjunction with the available work setting models, we can now also install these with our unique, noise-optimised brackets.



Slats with self-cleaning effect

With the help of sunlight and moisture, dirt and smog particles are removed, thus contributing to the self-cleaning effect of slats and the purification of air. 1000 m² of slats with Reynolux® EcoClean™ coating neutralise as much smog as 80 trees. The cleaning function of the slat is based on a light-sensitive titanium oxide coating (EcoClean™) which acts like a catalyst under solar radiation. Moisture is sufficient to remove loose dirt particles.



Get into the sun faster!

Our new quick patio motor (STM) is available specially for external venetian blinds on patio or balcony doors. The new STM motor releases a patio door in less than 20 seconds – this makes it 3x faster than a standard motor and significantly reduces inconvenient waiting times. However, the tilt and slat positioning takes place with the same speed as for venetian blind facade systems. The best thing about it: when installing external venetian blinds with the STM, nothing else has to be taken into consideration – planning costs and integration are the same as with standard motors.

Your advantage:

Unlike comparable solutions, the fast patio motor can be controlled just as easily as standard motors for external venetian blinds.



New guide profile end cap for front-mounted external venetian blinds

The new guide profile end caps are made of plastic and are simply clipped into the guide profiles. The guide profile end cap allows the easy connection of the guide profiles to window sills or their sill profiles

External venetian blinds

New products



Sales documents

	External venetian blinds	External venetian blinds	Venetian blind window systems	Asymmetrical external venetian blinds	Front-mounted external venetian blinds	Top-mounted external venetian blinds for new buildings	Fixing systems
Price lists	Purchase price list (Art. No. 877521) unchanged since 01.02.2015 Supplementary page for purchase prices (Art. No. 2011752) valid from 01.02.2016			Purchase price list (Art. No. 876646) unchanged since 01.02.2015	Purchase price list (Art. No. 2011757) valid from 01.02.2016	Purchase price list (Art. No. 2011947) valid from 01.02.2016	Installation price list (Art. No. 2011738) valid from 01.02.2016
Technical data	Technical data (Art. No. 2011741) and technical data application (Art. No. 2011744) valid from 01.02.2016			Technical data (Art. No. 876652) unchanged since 01.02.2015	Technical data (Art. No. 2011755) valid from 01.02.2016	Technical data (Art. No. 2011951) valid from 01.02.2016	
Collection	External venetian blind and roller shutter collection case incl. external venetian blind slat folder and colour folder as well as roller shutter profile folder and colour folder (Art. No. 876033) unchanged since 01.03.2012, slipcase with the same content as the case (Art. No. 876036) unchanged since 01.03.2012, exhibition folder (Art. No. 876038), unchanged since 01.03.2012						
Colour charts, colour fans	External venetian blind/roller shutter colour chart (Art. No. 2012213) unchanged since 01.06.2015, external venetian blind/roller shutter colour fan (Art. No. 875515) unchanged since 01.03.2012, external venetian blinds colour chart (Art. No. 878663) unchanged since 01.02.2015, WAREMA Colour World brochure (Art. No. 879528) unchanged since 01.03.2015						



	External venetian blinds	External venetian blinds	Venetian blind window systems	Asymmetrical external venetian blinds	Front-mounted external venetian blinds	Top-mounted external venetian blinds for new buildings	Fixing systems
Brochures	External venetian blind brochure (Art. No. 2013299)						
Complete prospectuses	Complete external venetian blind prospectus (Art. No. 2013296)						
Prospectuses	in accordance with the latest Marketing Material Catalogue 2016						



Proven perfection
WAREMA External
venetian blind 80 S



Unobtrusively beautiful

Instead of the lifting tape and cable guidance eyelets, the cut-outs can optionally also be executed with surrounding beaded edges. In this model too, the narrow lifting tape feedthrough guarantees that when the slats are closed, there are hardly any dots of light in the room. This version also guarantees the maximum tilt angle in cable-guided systems. We can thus promise you perfect functionality to meet all requirements.

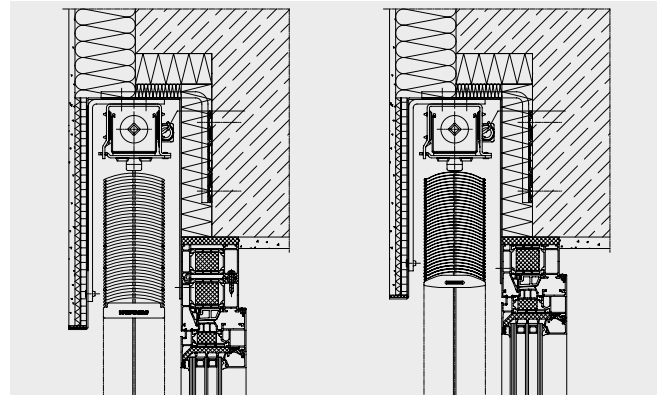

Positive effect on the energy balance

Thanks to the new slat geometry and the optimised bottom rail, the standard version of the new WAREMA 80 S external venetian blind offers the smallest slat package on the market. The lower slat stack height has a positive effect on the energy balance of buildings.



Everything is possible

All functions and models of the 80 mm beaded slat can also be realised with the 80 S. We also offer our beaded, 60 mm wide slats as the improved 60 S version. Here, the slat stack height is reduced by up to 10 %.



Product film

You can experience first impressions of the 80 S in our product film!

www.warema.com/80s

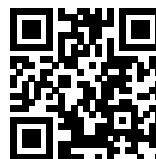

A photograph of a modern, multi-story building with a white facade and large windows. Each window is topped with a dark-colored roller shutter. The building has a contemporary design with a mix of white and light brown panels. A balcony with a glass railing and some outdoor furniture is visible on one of the upper floors. The sky is clear and blue.

Roller shutters

New products

We have taken the constantly rising demands on the energy efficiency of buildings as well as the trend towards larger and larger window surfaces as an opportunity to revise our range of top-mounted roller shutters. As a box system of hollow plastic profiles, the new WAREMA AU-RO top-mounted roller shutter offers numerous advantages compared to its predecessor. For example, the standard connection to the window using a clip system simplifies mounting. Structural optimisation was achieved using new window adapter profiles made of steel or using structural consoles. In addition, the new system features improved air tightness and thermal insulating values. Benefit from the new advantages! Available from February 2016.



Window connection using clip system

The new top-mounted AU-RO roller shutter offers a standard window connection using a clip system. By analogy to the new NA-RO, there is also a choice here of a window adapter profile made of plastic or, optionally, a window adapter profile made of steel to increase rigidity.

Here too, the new clip system in the AU-RO facilitates not only handling but also installation.

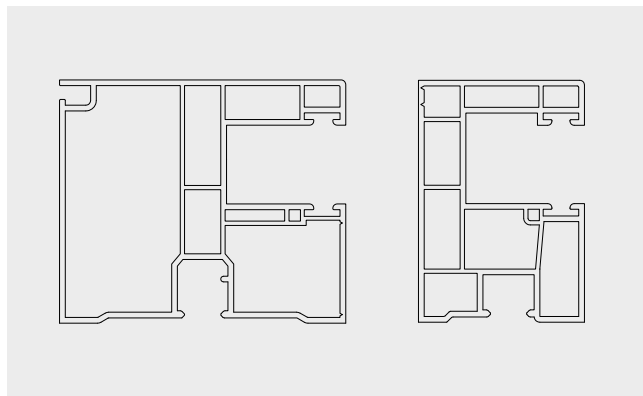

New guide rails

Besides the standard-width guide rails (60 mm), narrow guide rails with a visible width of 35 mm (plastic) and 40 mm (aluminium) are available. The narrow guide rails are drawn-in as standard, and thus allow lateral overlap insulation of the window, in compliance with the standard, without lateral enlargement.

An external end lock with a fixed 5° angle is also available, with immediate effect, for the standard plastic guide rail.

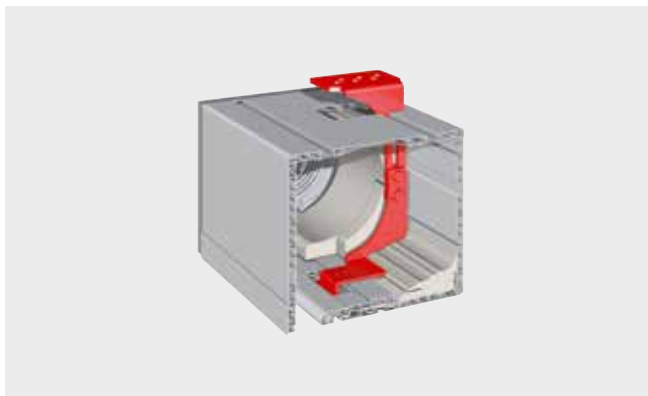

Optimising structural strength

A gradual improvement of the structural strength is optionally possible and can be achieved in different ways. From a width of 1600 mm, for example, a window adapter profile made of steel is available to increase the moment of inertia of the window.

If the required structural strength is still not achieved, structural consoles can also be used to allow the structure to absorb the load.

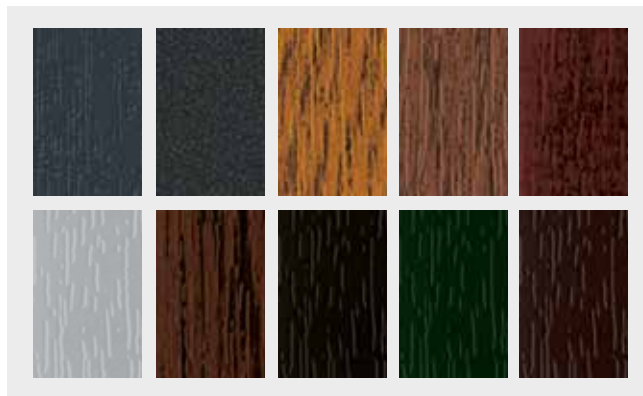

New portfolio with over a hundred laminates

In order to keep up with the current colour trends, a revised portfolio of laminates is available for the new AU-RO top-mounted roller shutters and the new NA-RO top-mounted roller shutters for new buildings.

A total of ten standard decors are available to cover the latest colours for laminated windows. Production using these colours is possible within a very short period of time. The three colours Anthracite Grey, Anthracite Grey ungrained and Golden Oak are even available with the same delivery period as a version in white plastic.

You can find out about delivery times as well as the surcharges for the large number of special decors available through your contact person in the Roller Shutter Customer Centre.

Available from February 2016, or immediately for NA-RO.

Roller shutters

New products

Sales documents

	Front-mounted roller shutters	Safety roller shutters	Asymmetrical roller shutters	Top-mounted roller shutters and top-mounted roller shutters for new buildings	Renovation roller shutters	Black-out systems
Price lists	Purchase price list (Art. No. 2011757) valid from 01.02.2016		Purchase price list (Art. No. 876646) unchanged since 01.02.2015	Purchase price list (Art. No. 2011947) valid from 01.02.2016		Purchase price list (Art. No. 876611) unchanged since 01.02.2015
Technical data	Technical data (Art. No. 2011755) valid from 01.02.2016		Technical data (Art. No. 876652) unchanged since 01.02.2015	Technical data (Art. No. 2011951) valid from 01.02.2016		Technical data (Art. No. 876607) unchanged since 01.02.2015
Application brochure	Roller shutter application brochure (Art. No. 875995)					
Collection	External venetian blind and roller shutter collection: Case incl. external venetian blind slat folder and colour folder as well as roller shutter profile folder and colour folder (Art. No. 876033) unchanged since 01.03.2012, slipcase with the same content as the case (Art. No. 876036), unchanged since 01.03.2012, exhibition folder (Art. No. 876038), unchanged since 01.03.2012					



	Front-mounted roller shutters	Safety roller shutters	Asymmetrical roller shutters	Top-mounted roller shutters and top-mounted roller shutters for new buildings	Renovation roller shutters	Black-out systems
Colour charts, colour fans	External venetian blind/roller shutter colour chart (Art. No. 2012213) unchanged since 01.06.2015, external venetian blind/roller shutter colour fan (Art.-No. 875515) unchanged since 01.03.2012, WAREMA Colour World brochure (Art. No. 879528) unchanged since 01.03.2015					Colour chart black-out blinds (Art. No. 876674) unchanged since 01.09.2013 WAREMA Colour World brochure (Art. No. 879528) unchanged since 01.03.2015
Brochures	Roller shutter brochure (Art. No. 2013299)					Black-out blinds brochure (Art. No. 876672)
Complete prospectuses	Complete roller shutter prospectus (Art. No. 2013320)					
Prospectuses	in accordance with the latest Marketing Material Catalogue 2016					



Awnings

New products

Benefit from our updated range of articulated arm awnings with the new types G60 and H60. The proven technology and further sales-promoting innovations – for example higher construction limit values and a new product design – will convince you! With the WAREMA Colour World, the aluminium parts of the awnings can now also be coated in up to five different finishes and in an even larger variety of colours.



Open articulated arm awning G60

With its delicate components, the open G60 articulated arm awning now provides shade for even larger areas. The proven technology ensures fast and easy operation. With their comfortable, warm light, integrated LED stripes in the front profile create a pleasant atmosphere on the patio. The WMS dimmer (LED) also makes it possible to adjust the brightness individually, and can be controlled easily and comfortably using the WMS hand-held transmitter.



Half-closed articulated arm awning H60

The H60 half-closed version also has all of the features of the new G60 articulated arm awning for you and your customers. Thanks to the integrated rain hood and the optional fabric bearing shell, the fabric is protected from rain and weather influences.



Cassette awning K50

With the K50 cassette awning, which we can now offer in a trendy design, it is now possible to provide particularly stylish shade for small areas. With its angular appearance, the K50 is ideal for modern cubic house architecture. Thanks to the particularly small installation distance from the wall and the ceiling, the K50 cassette awning integrates particularly well into small patios and balconies. The LED stripes integrated in the cassette create a pleasant atmosphere in the evening.

The K50 will be available from April 2016.



Pergola awning with valance roller blind

The valance roller blind of the WAREMA pergola awning P40 guarantees even more privacy. It offers ideal protection from low sun, light evening breezes and prying eyes. The valance roller blind can be fixed in position when it is extended, thus keeping it stable in windy conditions. The valance roller blind can be operated using a crank.

When the valance roller blind was introduced, the front profile of the P40 was adapted and now has the new dimensions of 113 x 74 mm (old 110 x 74 mm).



Window awnings with ZIP guidance: Unit widths up to 6 m

As a logical further development, we have extended our window awnings with ZIP guidance to a new width of 6 m. From a width of 4 m and more, the size 15 cover panel with acrylic fabric curtain is used with the standard guide rail (25 x 56 mm). On the other hand, screen fabric curtains in conjunction with the size 15 cover panel have the new wide guide rail (37 x 56 mm) from a width of 4 m. For Soltis fabrics, which are only supplied with the standard guide rail, the maximum width is limited to 4 m.

For unit widths up to 6 m, we offer a separate technology incl. purchase price list (Art. No. 2010817). You can also find the current prices in the purchase price list for awnings applicable as of 01.12.2015 (Art. No. 2010809).



WMS dimmer (LED) for WAREMA LED stripes

The WMS dimmer (LED) is ideal for switching and dimming WAREMA LED stripes. The light can be comfortably controlled by WMS – for example with the WMS hand-held transmitter or with WMS WebControl.



Radiant heaters in RAL 9005

The current radiant heater is available not only in the two RAL colours 9006 and 9016 (both in a satin finish) but is now also available in RAL 9005 (jet black, satin finish).

Limit stop for cassette awnings 550

With the publication of the new sales brochures on 01.12.2015, the bevel gear of the cassette awning 550 has an integrated limit stop. This prevents the gear from turning too far and thus winding the fabric incorrectly.



WAREMA Colour World

In order to simplify our colour concept, the WAREMA Colour World now also applies to all articulated arm awnings. Types 530, 550, 580 and the new type K50 still represent exceptions. These are available as standard in RAL 9016 or RAL 9006 (satin finish) and, subject to surcharge, can be coated in accordance with the WAREMA Colour World.

Discontinued products from 2016

Discontinued articulated arm awnings 630/650/730/740/750

The 600 and 700 articulated arm awning ranges are superseded by the new G60 and H60 models. The replacement date is 01.12.2015.

Discontinued P50 pergola awning

The P50 pergola awning is no longer available either.

Discontinued canopy awnings

The canopy awnings are no longer included in the new 2016 sales documents and will no longer be available from 01.01.2016.

Discontinued awning colour fan

The awning colour fan with its 50 frame colours will cease to be valid on 01.12.2015. The WAREMA Colour World will then take effect for all awning types, with the exception of the 500 range.

Discontinued valance roller blind with Acrylic All Weather fabric

The combination of valance roller blind and All Weather fabric will no longer be available when the new documents become valid on 01.12.2015.

Sales documents

	Cassette awnings	Articulated arm awnings	Patio side screens, fabrics	Patio roof and pergola awnings	Sun sails (S1)*	Conservatory awnings	Vertical, facade and drop-arm awnings, markisolettes	Window awnings with ZIP guidance
Price lists	Purchase price list for awnings (Art. No. 2010809) valid from 01.12.2015							
Technical data	Technical data for patio awnings (Art. No. 2010914) valid from 01.12.2015						Technical data for window awnings (Art. No. 877623) unchanged since 01.12.2014	Technical data for window awnings with ZIP guidance (Art. No. 877627) unchanged since 01.12.2014, technical data supplement for window awnings with ZIP guidance from 4 m unit width (Art. No. 2010817) valid since 01.07.2015
Application brochure	Awnings application brochure (Art. No. 874499)							
Collection	Awnings collection (Art. No. 876981) unchanged since 01.12.2012 Awnings commercial building collection (Art. No. 876985) unchanged since 01.02.2013 Awnings collection on hangers (Art. No. 876397) unchanged since 01.12.2012 Awnings collection brochure (Art. No. 875569) unchanged since 01.12.2012 Prices in accordance with the current Marketing Material Catalogue 2016							
Colour charts, colour fans	Screen colour chart (Art. No. 875542) unchanged since 01.02.2013 Soltis-92 colour chart (Art. No. 875542) unchanged since 01.02.2013 Acrylic fabrics, uni colour chart (Art. No. 875551) unchanged since 01.02.2012							
Brochures	Patio awnings brochure (Art. No. 2012922)				Only available for WAREMA sun sail partners*	Conservatory brochure (Art. No. 877584)	Window awnings brochure (Art. No. 875565)	
Complete prospectuses	Patio awnings (Art. No. 2012925)			Patio roof and pergola awnings (Art. No. 2010400)	Only available for WAREMA sun sail partners*	Conservatory awnings (Art. No. 877581)	Window awnings (Art. No. 877578)	

* All sales brochures for the movable sun sails types S2, S3 and S4 are only available for WAREMA sun sail partners and can be found in our current Marketing Material Catalogue 2016.

The background image shows a bright, modern living space with large floor-to-ceiling windows. The windows are fitted with light-colored roller blinds, some of which are partially lowered. Outside the windows, a city skyline with various buildings is visible under a clear sky. In the foreground, a portion of a light-colored armchair with a cushion is visible on the right. The overall atmosphere is clean and airy.

Internal sun shading systems

New products

We have revised our range of roller blinds, and in the course of this process, some simplifications will be introduced from 01.02.2016 onwards. The complex type key will be dispensed with. As an aid, a "list of translations" of the old and new roller blind designations will be included in the new Technical data incl. purchase price list. At the same time, the order forms will also be adapted, so that the required product can be ordered simply by ticking the appropriate box. For a better overview of the entire range, the roller blinds are divided into the categories bracket roller blinds, cassette roller blinds and special applications.



Bracket roller blind S

The new bracket roller blind S completes the bracket roller blind S. Besides the bracket roller blinds M and L, the new roller blind is available from 01.02.2016 for smaller units. Various equipment packages can also be ordered for this roller blind. An overview of all possible equipment packages and applications will be included in the new technical data, incl. purchase price list. The operating type LiteRise®, with which the height of the curtain can be selected simply by sliding the bottom rail, is new in our range of products.



Cassette roller blind XS

The cassette roller blind XS is installed on or in the glass profile. Thanks to the small cassette of only 33 x 33 mm, it can hardly be seen, yet still meets all of the requirements an internal sun shading system has to satisfy. This product is available in versions with guide rails and ball chains. To reduce the light gap, the guide rails are fitted with legs behind the curtain. On account of the small cassette, only fabrics that have a fabric thickness of ≤ 0.22 mm are suitable.



Project roller blind M

The project roller blind M is a bracket roller blind with chain operation and is specially designed for the requirements of the commercial sector. With a fabric collection adapted to this roller blind, it offers the ideal prerequisites for use in commercial projects. Additional features such as a metal chain are also possible, subject to surcharge.

Internal sun shading systems

New products



Glass profile venetian blind

From February 2016, we shall be offering a revised version of our glass profile venetian blind. The drive has been optimised, making low-noise operation possible. In addition, operating comfort has been improved through the use of different gear ratios (depending on the size). This allows even large units to be operated easily. There are also improvements in terms of appearance – the plastic housing of the chain drive will no longer be visible.



Discontinued products

Within the framework of the revision of our roller blind range, we shall be discontinuing the products basic roller blind and roller blind for building projects. These will be removed from the range as of 01.02.2016. As an alternative to the basic roller blind, users will be able to fall back on the bracket roller blind S. The bracket and cassette roller blinds M and L will serve as replacements for the roller blind for building projects.

In addition, the pleated blind FE (motorised, freely suspended unit) will be discontinued as of 01.02.2016. Alternatively, other operating types can also be used here.

In addition, we shall also be discontinuing the sun shading system for roof windows from 01.02.2016. From this point in time onwards, the products in question can no longer be ordered.

The insect screen roller blind for skylights will still be available.



Sales documents

	Venetian blinds	Vertical louvre blinds	Pleated blinds	Roller blinds	Curtain panels				
Price lists	Inside technical data incl. purchase price list (Art. No. 2010789) valid from 01.02.2016								
Technical data	Inside technical data for the commercial building sector (Art. No. 2010794) valid from 01.02.2016								
Application brochure	Application brochure for double-glazed facade venetian blinds (Art. No. 876240)								
Collection	Inside Collection (Art. No. 2010575) valid from 01.02.2016 Inside Commercial Building Collection (Art. No. 877750), unchanged since 01.02.2015 Prices in accordance with the current Marketing Material Catalogue 2016								
Collection brochure	Inside Collection brochure (Art. No. 2010623)								
Brochures	Inside brochure (Art. No. 2013188)								
Complete prospectuses	Complete Inside prospectus (Art. No. 2013160)								

Internal sun shading systems

New Inside Collection



The Inside Collection will convince you through its comprehensive choice of colours and qualities. The new, structured design makes working with the collection simple and intuitive. Thanks to this well thought-out, systematic approach, specific parts of the collection can be updated, and colour charts can easily be sorted and put away again after you have advised the customer. The new Inside Collection replaces the entire Inside Collection 2009 as from 01.02.2016. The Inside Commercial Collection remains part of the product range.



Collection folders

The Inside Collection slipcase, with its comfortable handle, comprises three collection folders:

- roller blinds, curtain panels and vertical louvre blinds
- pleated blinds and
- internal venetian blinds

Within the collection folders, the content is organised according to degrees of transparency, making it easier to offer specific expert advice.



Transparency chart and design overview

The right fabric can be selected either through the required degree of transparency or through the required colour. Each collection folder contains a transparency chart to help you to select the right degree of transparency. It also contains a structured design overview, which gives an initial insight into the varied colours, structures and patterns of the new collection.



Colour charts and venetian blind colour fans

Each collection folder contains a wide choice of colour charts that meaningfully present the many different qualities and colours of the collection. On the right-hand side of the collection folder in question, the colour charts are systematically ordered according to the four different degrees of transparency. The left-hand side shows colour charts that represent the latest trends. The venetian blind collection folder contains four colour fans showing an overview of the colour range for each slat width.



Documents and file holders

A practical file holder is also part of the collection. This contains a collection brochure with useful information for consultation meetings, for example fabric and slat data. Technical data incl. purchase price list are also integrated. All of the documents required for consultations are thus kept together in the collection and are within immediate reach.

Control systems

New products



WAREMA climatronic® WebControl allows the operation of the WAREMA climatronic® system by means of an app – for even more comfort. The system can be operated using a PC, laptop, smartphone or tablet.



WAREMA climatronic® 3.0

In Version 3.0, the WAREMA climatronic® system can also be operated with WAREMA climatronic® WebControl. It is possible to upgrade the WAREMA climatronic® 2.0 to 3.0; if you are interested, please get in touch with your contact person at Technical Service.

Our WAREMA climatronic® 3.0 has also been given new article numbers; these can be found in the supplement for Technical data incl. purchase price list for control systems (Art. No. 2010873).



New KNX and SMI actuators

In the 2nd half of 2016, new KNX and SMI actuators will be available.

KNX

- 8M230: optimisation of the actuator
- 4M230: new actuator with improved reaction to floor plans and available space in the building project
- 4MDC: 24V venetian blind actuator
- KNX MCM: individually programmable, modular BAline system for KNX, which all consumers and sensors in a room can be connected to

SMI

- New SMI actuators for LON and WAREMA climatronic® bus systems

Control systems

New products



WMS dimmers (LED)

The WMS dimmer (LED) is ideal for switching and dimming WAREMA LED stripes in awnings. The light can be dimmed and switched using a WMS transmitter, for example the WMS hand-held transmitter or WMS WebControl.



WMS WebControl - new functions

WMS WebControl can now use the time switch function for up to four different time switch points per day and receiver.

With this, move commands and also automatic sun control can be carried out by means of a time switch point. Time switch points can be set and changed directly using your browser, whether with a tablet, smart phone or PC. A precondition for the use of this function is simply a new, free update of the WMS WebControl hardware by means of an SD card.



Sales documents

	EWFS radio system	WMS radio system	Central control systems	WAREMA climatronic®	Bus systems
Price lists	Technical data incl. purchase price list for control systems (Art. No. 877494), unchanged since 01.01.2015 Supplement for Technical data incl. purchase price list for control systems (Art. No. 2010873), valid from 01.01.2016				
Technical data					
Brochures	Control systems brochure (Art. No. 2013128)				
		WMS brochure (Art. No. 877721) valid from 01.04.2015		WAREMA climatronic® brochure (Art. No. 877483)	Bus systems brochure (Art. No. 874980)



2008670/12.2015